

HSP

Recommended P.C.B Layout(Top Side)
(PCB BOARD TOLERANCE± 0.05)

NOTES:

Current Rating: 5.0A,AC/DC
 Voltage rating: 250V AC/DC
 Insulation Resistance: 1000M Ω /Min
 Withstand Voltage: 1500V AC/minute
 Operation Temperature: -25 $^{\circ}$ C to +85 $^{\circ}$ C
 Applicable Pcbord thickness: 0.63"(1.6mm)
 Contact Resistance: 10m Ω ? Max

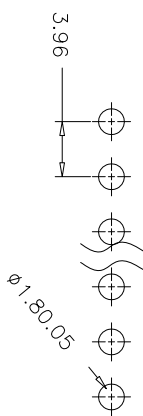
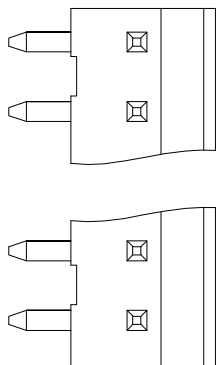

Dimensional & Ordering Information

Circuit	Part No.	Dimension	
		A	B
02	BT3961R02*W01	3.96	7.92
03	BT3961R03*W01	7.92	11.88
04	BT3961R04*W01	11.88	15.84
05	BT3961R05*W01	15.84	19.80
06	BT3961R06*W01	19.80	23.76
07	BT3961R07*W01	23.76	27.72
08	BT3961R08*W01	27.72	31.68
09	BT3961R09*W01	31.68	35.64
10	BT3961R10*W01	35.64	39.60
11	BT3961R11*W01	39.60	43.56
12	BT3961R12*W01	43.56	47.52
13	BT3961R13*W01	47.52	51.48
14	BT3961R14*W01	51.48	55.44
15	BT3961R15*W01	55.44	59.40
16	BT3961R16*W01	59.40	63.36
17	BT3961R17*W01	63.36	67.32
18	BT3961R18*W01	67.32	71.28
19	BT3961R19*W01	71.28	75.24
20	BT3961R20*W01	75.24	79.20

Ordering Information

BT3961 R * * * W 0 1 A11

Terminal Shape No.of Pins Contact Plating Color Packing
 S=Water 180 $^{\circ}$ 02P-20P Empty=Tin Plated W=White 0:PE Bag
 R=Water 90 $^{\circ}$ X=10u"Gold U=Gold Flash E=Beige 1:Tray
 W=15u"Gold X=10u"Gold Y=20u"Gold 2:Tape
 Z=30u"Gold F=Gold Flash/Tin 3:Tape&Reel

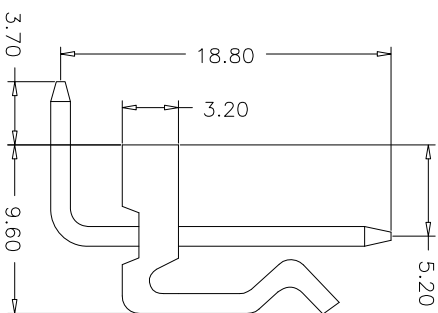
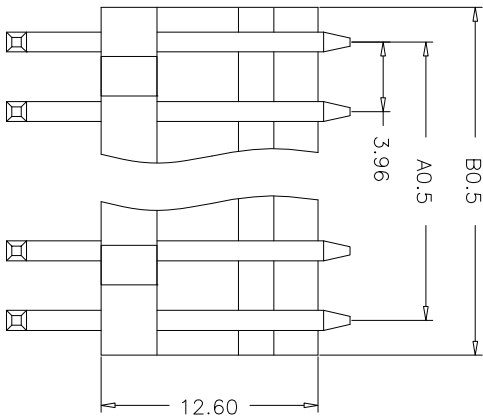

REV	DATE	MODIFICATION DESCRIPTION	CHANGE	APPROVE	OPERATION	DRAW	SCALE	PART NO.	TITLE:
A0	09/01/19	NEW			XX ±0.40	Zhongyatin	1/1	BT3961R***W01A11	Wafer 3.96mm Pitch 90 $^{\circ}$
					XXX ±0.25	DESIGN	A4		
					Angle ± 3	CHECK			
					DIM	APPROVE			



BMA TECHNOLOGIES LTD